

// EAST SECTION @ S STREET THROUGH S STREET GATE & DIRECTORS LOUNGE



UPPER CONCOURSE OPEN SPACE & BAR WITH VIEWS DOWN S STREET TO THE WATER

MECHANICAL EQUIPMENT LOCATION WITH ALUMINUM PERFORATED SCREEN WALL

19 EAST SUITES

DIRECTORS CLUB

DEEP TRAY LIVING GREEN ROOF

1ST STREET RETAIL

S STREET ENTRY GATE PLAZA

S STREET ENTRY GATE WILL BE SECURED WITH S.S. MESH COILING OVERHEAD DOORS. THE LOCATION IS SET BACK TO MAINTAIN AS MUCH OPEN PUBLIC PLAZA SPACE AS POSSIBLE. THE QUEUING AND SECURITY PROCESS WILL BE MANAGED WITH PORTABLE MAGNETOMETERS AND PORTABLE RAILS. THE S STREET GATE IS TECHNICALLY PART OF THE EASEMENT AGREEMENT WITH PEPCO SO ALL EQUIPMENT IS REQUIRED TO BE PORTABLE

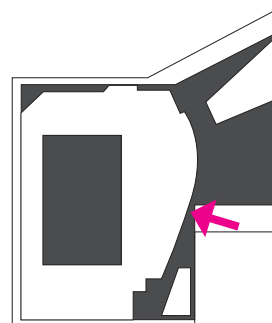

BUILDING
FACADE
MATERIALS

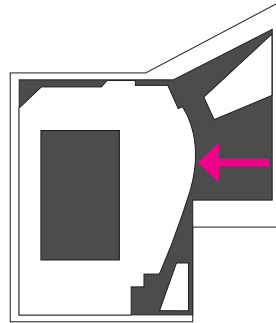

ENGINEERED WOOD
GFRG TYPE 1
ANODIZED ALUMINUM
CURTAIN WALL
INSULATED GLAZING

GFRG TYPE 2
GFRG TYPES 2 & 3
GFRG TYPES 4

ANODIZED ALUMINUM 1"
PERFORATED METAL
MECHANICAL SCREEN WALL

ANODIZED ALUMINUM
CURTAIN WALL
INSULATED GLAZING

GFRG TYPE 1
ANODIZED ALUMINUM 1"
PERFORATED METAL